

1993

SR SUNTOUR
BICYCLE EQUIPMENT



ENGLISH

Lighter, Stronger, Smoother, Safer ... and Comfortable.

"PRODUCT HIGHLIGHTS"

SA SUNTOUR...

An evolution in comfort, safety, lightness and durability.

- *Our popular Index Shifting System is improved with a newly engineered cog set and is enhanced with the addition of a more powerful braking system.*
- *Maintaining its lightweight and compact design MD expands to 8-speed. It also includes brand new Micro Claw Clipless Pedals (XC-PRO) and newly designed Cantilever brakes (XC-PRO and XC-COMP).*
- *Introducing the new XC-EXPERT MD. The addition of this group expands MD to reach a wide range of riders.*
- *Originality in Appearance and Performance; S-1 is a breakthrough in the appearance and design of derailleurs and shift levers. Combining superior performance, a fashionably sleek look, and an impact protective design the S-1 challenges conventional shifting systems.*
- *The Twist Shifter is easy to use and makes shifting easy to understand. Not only does it provide smooth shifting on the road, it will withstand the rigors of off road riding.*
- *Improve your braking efficiency exponentially. This small product offers increased leverage and safety. Nothing else comes close.*
- *The SL road group includes an 8-speed cassette!*
- *Suspension that is designed for the roughest terrain but will also absorb the bumps and vibrations of rough roads and jarring trails. Continuing a tradition of design and manufacturing excellence, this fork is a combination of high performance and good value, and is maintenance free.*
- *PowerFlo, formerly found exclusively on the most upper end SUNTOUR groups is now included as a standard component in all of our groups. Incorporating beveled-cut cog teeth and shifting ramps the rider is guaranteed quick and accurate shifting.*



FEATURES

MicroDrive's Compact Design Results in Weight Reduction and Efficiency

SUNTOUR MD
 MICRO DRIVE DESIGN



The compact design includes smaller chainrings, smaller cogs, shortened bottom bracket axle, a Super low profile crank and a shortened rear derailleur cage. The result is a dramatic weight savings. In addition there are other advantages including more energy-effective pedaling, increased ground clearance, less chances of chain jam, and a reduction in the number of overlapping gear ratios.

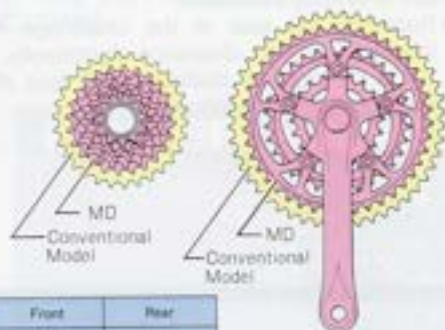

Another MicroDrive Advantage: The Ability to Achieve a Wider and More Effective Gear Ratio.

Less duplication of ratios means more gear combinations. Reducing the need to shift between chainrings increases the rider's pedaling efficiency.

	Front	Rear
MD185	42-32-20	11-28T
MD175	42-32-20	11-28T
Conventional Model	48-36-24T or 48-30-28T	12-28T or 13-30T

GEAR RATIO COMPARISON CHART OF (MD) AND CONVENTIONAL MODEL

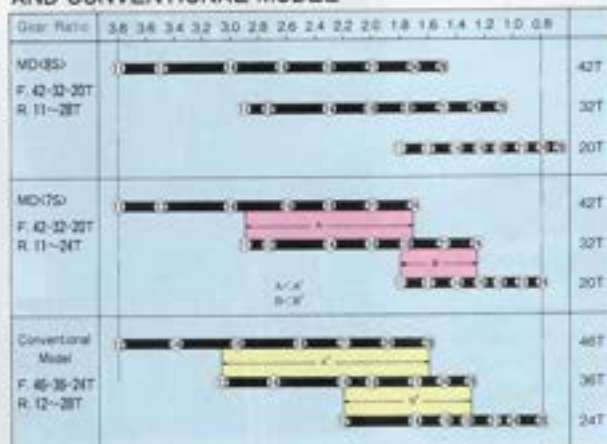

8-Speed Cassettes are Standard Equipment

1993 MD introduces an "11-28T" 8-speed cassette which will allow riders to achieve even wider gear ratios while maintaining quick and precise shifting. Coupled with standard 42X32X20T chainrings this wide ratio performs superbly in all riding situations including steep hill climbing and fast descents. A 44T, 46T optional chainring is also available.

'93 NEW

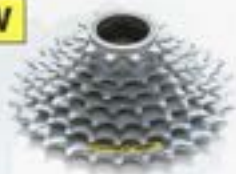

FEATURES

The Core of MicroDrive-An 11 Tooth Cog

With an 11-24 (7S) or 11-28 (8S) and a short cage rear derailleur, shifting is fast; smaller jumps between gears means less chain travel resulting in a quicker response, SR SUNTOUR has successfully developed an 11T cog which eliminates chain skip as a result of its chamfered teeth and makes MD the most efficient DRIVETRAIN system.



Smaller Components Mean Bigger Advantage

Smaller Chaining means increased frame clearance

- The smaller diameters of the front chainrings mean increased clearance at the chainstays, improving tire clearance. This extra space also means that chainstay dimpling can be reduced or eliminated. The 20T inner chaining fits over the bottom bracket shell, so chain jam is virtually eliminated.
- Reducing the size of the chainrings has also increased ground clearance significantly, allowing riders to negotiate obstacles with less chance of damage to their equipment.

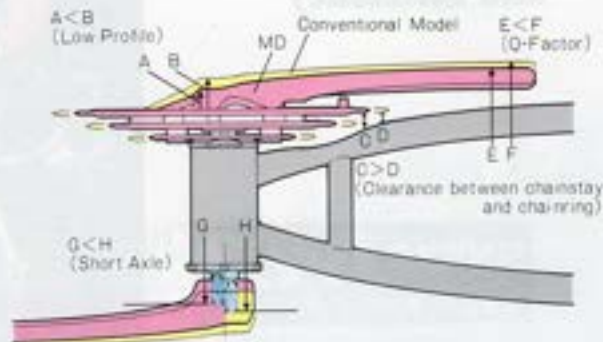

Super low profile MD cranks

- Cold forged MD cranks offer a lower profile for more efficient pedaling and effective lower Q-factor.

Smaller gear ratio on the cassette cogs and short cage rear derailleur means faster, smoother shifting

- The MD shifts as responsively as a road drivetrain. Smaller jumps between gears means less chain travel and a quicker shifting response.

PowerFlo Cogs Improve The Performance of All SUNTOUR Shifting Systems. They Are The Ultimate for Smooth Precise Shifting

A beveled cut in the design of the cog assists the chain's movement resulting in a faster, smoother, quieter shift. Strategically positioned ramps actually lift the chain while it shifts, reducing the stress and flex on the chain. This means you'll reduce the chance of chain breakage and increase the life of the chain. A deep trough between each tooth allows for better chain/cog interface resulting in better performance.

Beveled-cut cog teeth of the Power Flo requires slightly lifted chain position when shifting.



- PowerFlo is available on most of SR SUNTOUR's Drivetrain component groups.
- The following chains are recommended for use with the PowerFlo cog. CH-AP01, CH-AP02, CH-AP11, CH-AP12, CH-AP15, CH-AP21

POWERFLO



FEATURES

**Lighter Components, Compact Designs,
and Improved Performance**
**This Describes Our New 1993 Cantilever
Brake System and MicroClaw Clipless
Pedals**

Brake-System '93 NEW

< XC-PRO MD, XC-COMP MD >

BRAKE LEVERS

- Simple compact lever design with an elegant finish
- An innovative design attains the optimum balance of modulation and power, increasing mechanical advantage dramatically
- Weight: 163g (XC-PRO MD, XC-PRO, XC-COMP MD, XC-COMP)



Clipless-Pedal '93 NEW

MICRO CLAW

Lighter, Stronger, Faster

- Lighter weight and higher rigidity
- Single piece body is a stronger design for high impact resistance
- Double sided retention for faster entry and effortless release
- Drilled catch-plate reduces weight and prevents mud build up



CANTILEVER ARMS

- Sleek low-profile design
- Cold forged produces a lightweight arm with a beautiful finish
- Dual out board spring tension adjusters facilitate set up and adjustment
- Arms are mounted closer to the studs with a precision sleeve, eliminating chatter and increasing the rigidity
- Weight: 173g (XC-PRO MD, XC-PRO, XC-COMP MD, XC-COMP)

POWER HANGER

**Increase Braking
Efficiency
Exponentially**



'93 NEW

Lightweight, and simple the Power Hanger improves your braking and adds safety. Replacing the conventional cable carrier, and acting as a mechanically assisted transverse carrier, cable slack is eliminated. The result is increased leverage and incomparable modulation.

In the event of a cable breaking, it prevents the cable from dropping onto the tire and locking the front wheel.

Without exception, the Power Hanger is the best way to increase your braking power.

Model: PL-XP10 (Titanium axle)
Model: PL-XP11 (Chromoly axle)
Weight: 410g (PL-XP10), 455g (PL-XP11)
Note: Compatible with SPD shoe sole

SUNTOUR S-1

Innovative Design with a Unique Appearance



'93 NEW

S-1 Rear Derailleur

Revolutionary Design with a Non Traditional Appearance

The S-1 system is a breakthrough that is a step ahead of conventional shifting systems.

Low profile, Protected Derailleur Position

The special mounting position of the S-1 system puts the derailleur under the chainstay in a low profile, protected position. Even if the bike is dropped onto its right side, the derailleur will not touch the ground.

Simple Built-in Index Cam

With an index cam built directly into the derailleur the need for derailleur adjustments is virtually eliminated. A "direct link" cable attachment system reduces the overall cable length and eliminates the chainstay casing loop, for more efficient trouble free operation.



TWIST SHIFTER



S-1 Twist Shifter

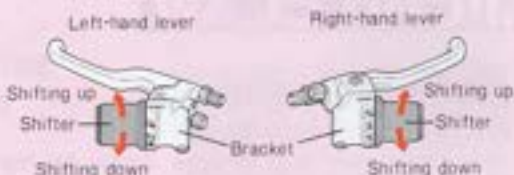

INDEX CONTROLLER CAM SYSTEM IN THE REAR DERAILLEUR

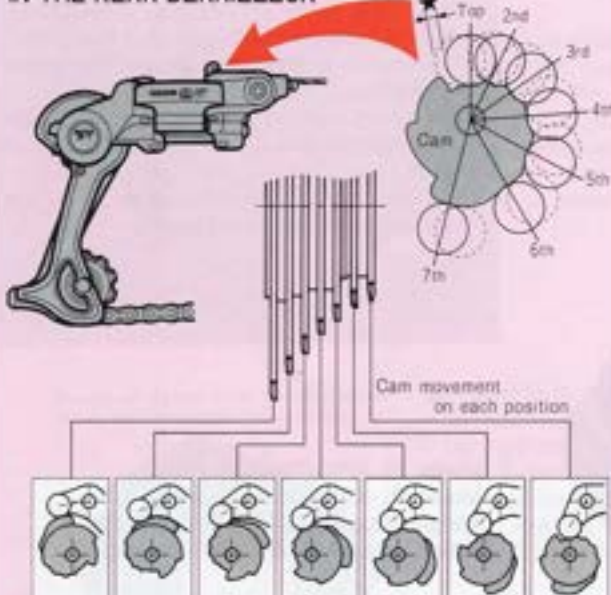

Easy to Use

The ergonomic design of the TwistShifter rotates both grips in the same direction for shifting up or down. There is no confusion about how to make it easier or harder to pedal. The gear position is also indicated on each lever.

Sleek, Comfortable Grip

Comfortable anatomical grips utilize the method of partial bar-grip rotation. Reduces the clutter of levers on the handlebars.

Durable and Impact Resistant

Mounted inboard of the grip, this arrangement puts the lever in a position that will protect it from damage, in most accident situations.

There are not protruding levers or buttons susceptible to breakage.

*The S-1 drivetrain is an integrated system. The S-1 rear derailleur must be used in conjunction with the S-1 Twist Shifter.
 *The S-1 rear derailleur requires a special chainstay brake on.

FEATURES

SUNTOUR Shift Levers; Quick, Positive, Easy and Comfortable

SR SUNTOUR's shift levers are ergonomically designed and safety oriented. A wide variety of models fits the diversified needs of all riders.

TWIST SHIFTER

SUNTOUR **MT**
MULTI TERRAIN

Specifically designed for off-road use, MT Twist Shifter is a breakthrough in mountain bike shifting.

* MT-Multi Terrain



'93 NEW

In the past, conventional grip-type shift levers were only suitable for recreational riding and not applicable for hard off road riding.

We at SR SUNTOUR have explored and improved the concept of conventional grip-type shifting through extensive research and development. The result is a mechanism which is well suited for both city and rugged off road use. The new MT Twist Shifter works easily for riders of all levels.

- Shifting is easy to understand. Eliminating buttons and levers, shifting becomes a reflex instead of a confusion of multiple choices. Both grips rotate in the same direction to achieve the same shifting effect

- Compact shift unit does not compromise the length of the handlebar grip and reduces the clutter of levers on the bars

- Safe easy shifting without removing hands from the handlebars

- MT Twist Shifter can be used on any bike set up with upright handlebars.

WISHBONE



The Wishbone features a unique Y-shaped lever that allows the riders to make shifts ergonomically without removing their hands from the grips. It also features Multi-Mount positioning, making personalized anatomical placement of controls possible for the rider. It improves brake lever handling, too. Wishbone levers also allow for customized brake lever positioning.

X-PRESS



Easy, Positive shifting without changing your grip. X-Press shift levers let the rider shift without compromising braking or steering control. Even ATB beginners can enjoy quick shifting with their most comfortable hand position.

THUMB-SHIFTER



The standard for high performance mountain bike riding. Thumb shifter with Multi Mount system gives riders true brake and shift lever positioning flexibility.

COMMAND

Designed for drop handlebars, Command Shifters allow the rider to shift gears while riding on the brake hoods or the drop position, without removing their hands from the bars. Ideal for racers, Triathletes, or tourists. Ergonomically designed, and lightweight (185g).



FEATURES

SR SUNTOUR Represents Innovation and Evolution

We at SR SUNTOUR believe that continuous modification to improve our products is a must. Innovation to create new and unique designs is equally important. However compatibility and versatility through the years is considered at each step of the process.



GREASE GUARD



The 30 Second Overhaul Without Disassembling a Thing.

Keeping your bike in tiptop shape has never been easier. The new WTB/SUNTOUR Grease Guard System lets you clean and lube your hubs, bottom bracket, headset and pedals in just a matter of seconds. It's simple. As you inject new WTB/SUNTOUR grease into the convenient injection ports, you purge out the used and contaminated grease. Grease Guard is available on our state of the art XC-PRO and XC-PRO MD component groups.

MICRO LITE



The ultimate in lightweight racing components.

A component upgrade option for those who count their grams.

MicroLite components offer a weight savings of almost half a pound! MicroLite replaces standard steel bottom bracket cups, steel front hub axles, and steel freehub bodies with lightweight duraluminum alloy pieces. Rigidity and strength are retained while weight is reduced.

SE

Super Low-Profile SE Cantilevers



Super Low-Profile Self Energizing Brakes use the directional force of the rim to increase braking energy. As the pads contact the rim they are pulled forward toward the seatstay; the brake's internal helical mechanism drives the pads onto the rim with greater force. Compact, the new SE Low-Profile has an all new, low profile design that tucks the brake arms out of the way for greater heel clearance and less chance of impact.

CARTRIDGE BEARING



ROTATIONAL RESISTANCE UNDER LOAD
Cartridge Bearing Hub/Conventional Hub

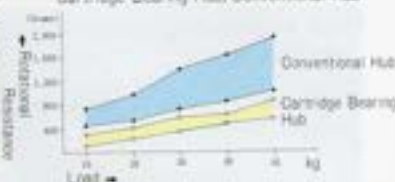

You'll appreciate having reduced rolling resistance and complete bearing protection.

Utilizing extremely high precision machining technology, the "contact surface" of the balls inside the bearing are machined within a tolerance of 0.001 millimeter. Under load, rotational resistance is reduced to less than half that of standard bearing systems. Replacement and adjustment of this system is very easy and a double seal mechanism completely isolates the bearings from impurities.

POWERING

Smooth Shifts, Reduced Chain-Suck.



Specially shaped teeth, combined with a specially profiled side pattern on the chainrings, help the chain shift down without hanging up and jamming. Mounted to the outer chainring is an anti-jam pin, which keeps the chain from getting jammed between the crank arm and the chainring.

ATB GROUP

SUNTOUR XC PRO **MD** SUNTOUR XC PRO

'93 NEW



The State of The Art

XC-PRO MD, the flagship group of the XC family and the state of the art in off-road components, continues to play a major role world wide, in the sport of mountain biking. Careful production steps as well as skillful design work, careful material selection, cold forging manufacturing process, high precision machining and meticulous assembly make XC-PRO truly dependable ATB components. They are the choice of championship riders.



SUNTOUR XC COMP **MD** SUNTOUR XC COMP

'93 NEW



The Components for High Performance Cyclists

Akin to the XC-PRO, (without the benefits of GreaseGuard) XC-COMP is also ranked as a top of the line race ready group. It performs smoothly and reliably on any terrain.



SUNTOUR XC LTD



Versatile, Durable, and Cost Effective

Designed to satisfy the needs of all riders, this versatile group will provide dependable performance whether it is recreational riding or rigorous off road riding.

SUNTOUR **XC EXPERT MD**

'93 NEW



**8 Speed MicroDrive
At a Lower Price Point**

SR SUNTOUR's new technology focuses on weight reduction, quick and precise shifting, and powerful braking. Following in the footsteps of top of the line XC, XC-EXPERT also includes 8-speed MicroDrive, PowerFlo cogs, Low profile brakes and Twist Shifter.



SUNTOUR **X-1**

'93 NEW



SUNTOUR **XCE**



SUNTOUR **XCM**



SUNTOUR **XC SPORT**

'93 NEW



SUNTOUR **S-1**

'93 NEW



**Innovative, Mechanically Simple,
and Easy To Use
Perfect For All Cycling Applications**

Consisting of a unique derailleur and our Twist-Shifter levers the S-1 is designed to be easier to use, to eliminate the need for cable adjustments and to protect the derailleur from impact damage. The S-1 is compatible with all bicycle designs; road bikes, mountain bikes and hybrids.

ROAD GROUPS

SUNTOUR SUPERBE PRO



SR SUNTOUR's Commitment to Perfection

Nothing is spared when it comes to designing SUNTOUR's state of the art road racing components. Combining the finest materials and manufacturing processes with winning designs SUPERBE-PRO represents the ultimate in racing equipment. Cold forging, cartridge bearings, and an elegant finish are a few of the features that make this the choice of professional riders and mechanics the world over.

SUNTOUR SUPERBE PRO TRACK



With its long history of dependable and unparalleled performance SUPERBE PRO has become a tradition in track racing. Its reputation makes it the favored equipment of the world's top track racers.

CRANK SET

Model: CW-6000

Specifications

- Taper size: SUPERBE
- Bolt circle diameter: 144mm
- Available chainrings: 44T~54T
- Crank length: 165.0, 167.5, 170.0, 172.5, 175.0mm
- Weight: 625g (49T/L=165mm)

PEDAL

Model: PL-2000

Specifications

- Thread: BCB/16"×20T (English)
- Weight: 278g/pr.

HUB

Model: BH-1600

Model: BH-1800 (NJS)

Specifications

- Overlocket dimension: 100mm (Front), 120mm (Rear)
- Number of holes: 28r, 32H, 36H (NJS)
- Thread: BCI.37"×24T (English)
- Weight: 525g/pr.

TRACK LOCK RING

Model: HC-900

Specifications

- Compatible cog: 12T, 13~17T
- Weight: 21g (12T)

TRACK COG

Model: HC-100

Specifications

- Compatible chain: 1/2"×1/8", 1/2"×3/32"
- Cog size: 12T, 13T, 14T, 15T, 16T, 17T
- Weight: 41g (14T)

SUNTOUR SL



'93 NEW

Lightweight Concept

Designed for use where light-weight and high performance are critical, SL components are the choice of serious cyclists. Built with the demands of racing in mind, SL components offer compact size and a simple, clean appearance. MicroLite, extreme light-weight hubs and bottom bracket line up and practical 8-speed drivetrain are the new addition to the SL component group.

SUNTOUR FS-E



A Multi Purpose Group

SUNTOUR BLAZE



MICRO LITE



FRONT HUB <SL>

Model: HB-SL10-F

Specifications

- Overlocknut dimension: 100mm
- Number of holes: 24, 28, 32H
- Weight: 180g



FREE HUB <SL> (7-SPEED)

Model: FH-SL10-7

Specifications

- Overlocknut dimension: 126, 130mm
- Number of holes: 28, 32H
- Weight: 405g



BOTTOM BRACKET

[SUPERBE-PRO]

Model: BB-SB20-E

Model: BB-SB20-I

[SL][XC-PRO/MD]

Model: BB-SL10-E

Model: BB-SL10-I

Model: BB-SL10-73

Specifications

- Features: WTS SUNTOUR Grease Guard System
- Taper size: SUPERBE (SUPERBE-PRO) VX (SL, XC-PRO/MD)
- Thread: BC1.37"×24T(English) 36×24T (Italian)
- B.B. Width: 68mm (English) 70mm (Italian) 73mm (Oversize)
- Weight: 265g (SUPERBE-PRO) 270g (SL, XC-PRO/MD)



SUSPENSION HUB

Model: HB-SU10-F

Specifications

- Overlocknut dimension: 100mm
- Number of holes: 32, 36H
- Weight: 210g



FREEWHEEL (7-SPEED)

Model: FW-WT10-S7 (WINNER)

Specifications

- ACCUSHIFT PLUS Compatible
- Thread: BC 1.37"×24T
- Compatible "B" dimension: 37mm
- Standard gear ratio: 12×13×14×15×16×17×18T 12×13×14×15×17×19×21T 13×14×15×16×17×19×21T 13×14×15×17×19×21×23T



SEAT POST BINDER

Model: SB-XP00

Specifications

- Useful skewer length: 19~38.5mm
- Weight: 50g



BAR END CONTROL (7-SPEED)

Model: SL-BC01-R7

Right/Index

Model: SL-BC01-L

Left/Power

Specifications

- ACCUSHIFT PLUS Compatible
- Clamp diameter: 18.8~22.2mm
- Weight: 188g



COMMAND SHIFTER

(7-SPEED)

Model: SL-CD01-R7

Right/Index

Model: SL-CD01-L

Left/Power

Specifications

- ACCUSHIFT PLUS Compatible
- Mounting position: Handlebar
- Weight: 185g



FRONT DERAILLEUR (BRAZE-ON)

Model: FD-BR01-GXB

Specifications

- Gear capacity: 24T
- Chaining differential: 7~11T(Outer~center)
- Weight: 120g



FRONT DERAILLEUR (TOP-PULL-PRO)

Model: FD-TP10-GXH

Specifications

- Gear capacity: 24T
- Chaining differential: 7~11T(Outer~center)
- Clamp diameter: 1-1/8" (28.6mm) 1-1/4" (31.8mm) 1-3/8" (34.9mm)
- Weight: 115g/1-1/8" (28.6mm)



FRONT DERAILLEUR (TOP-PULL)

Model: FD-TP01-GXH

Specifications

- Gear capacity: 24T
- Chaining differential: 7~11T(Outer~center)
- Clamp diameter: 1-1/8" (28.6mm) 1-1/4" (31.8mm) 1-3/8" (34.9mm)
- Weight: 114g/1-1/8" (28.6mm)



VICE GRIP

Model: OT-GP10



GRIP (FOR TWIST SHIFTER)

Model: GP-S100



POWER HANGER

Model: OT-PH00

Specifications

- Material: Aluminum



TRANSVERSE CABLE STOP

Model: OT-SH00

Model: OT-SH01 (for DuoTrack)

Specifications

- Material: Steel
- Use: Prevents the transverse cable from interfering with the wheel.



CABLE STOPPER

Model: OS-S100

Specifications

- Mounting position: S-1 braze-on boss For use of a regular type of rear derailleur



SEALED CARTRIDGE BEARING PULLEY SET

Model: BP-100

Specifications

- Material: Darlin
- Use: Rear derailleur



CABLE CASING STOP

Model: OS-410

Specifications

- Material: Aluminum alloy (Body) Steel (Mounting bolt & adjuster)
- Use: Down tube casing stop

**SCOPE LIGHT KIT**

Model: OT-SC00-D
Light & Holder set/For DR
Model: OT-SC10
Holder (DR) only
Specifications

- **Material:** Aluminum alloy
- **Battery:** "AA" alkaline × 2pcs
- **Maximum Intensity of Illumination:** 27 Lux (W/2.2 volt bulb)
- **Use:** Quick release hub

**SCOPE LIGHT KIT**

Model: OT-SC00-H
Light & Holder set/For Handlebar
Model: OT-SC20
Holder (Handlebar) only
Specifications

- **Material:** Aluminum alloy
- **Battery:** "AA" alkaline × 2pcs
- **Maximum Intensity of Illumination:** 27 Lux (W/2.2 volt bulb)
- **Use:** Handlebar
- **Clamp diameter:** 22.2mm, 25.4—26.2mm

**1 SUNTOUR LOGO STICKER (LARGE)**

Model: OG-SS00
Specifications
● **Size:** 270×295mm
● **QTY:** Set of 2pcs

2 SUNTOUR LOGO STICKER (SMALL)

Model: OG-SS10
Specifications
● **Size:** 300×63mm
● **QTY:** Set of 10pcs

3 SUNTOUR FRAME STICKER

Model: OG-SS20-W
Model: OG-SS20-B
Specifications
● **Size:** 110×22mm
● **QTY:** Set of 20pcs
● **Color:** White (OG-SS20-W)
Black (OG-SS20-B)

**WATER BOTTLE**

Model: PE-1200
Specifications
● **Material:** Polyethelene
● **Capacity:** 750ml (Large)
500ml (Small)
● **Color:** Blue, Red

**APRON**

Model: PE-1800
Specifications
● **Material:** Cotton
● **Size:** One size fits all
● **Color:** Red

**SHOULDER HOLDER**

Model: OG-SH00
Specifications
● **Material:** Nylon
● **Size:** 240×240×50mm
● **Color:** Black

**WHEEL COVER**

Model: PE-1500
Specifications
● **Material:** Stretch nylon
● **Fitting wheel size:** 700C
● **Color:** Blue

**CHAINSTAY PROTECTOR**

Model: OT-CP00
Specifications
● **Material:** Vinyl
● **Use:** Protects chainstay
● **Color:** Black

**CAP**

Model: OG-YC00
Specifications
● **Material:** Nylon 80% Cotton 20%
● **Size:** One size fits all
● **Color:** Day-Glo Yellow

**HEAD BAND**

Model: PE-2100
Specifications
● **Material:** Cotton
● **Size:** One size fits all
● **Color:** Blue, Red

**CYCLE BANDANA**

Model: PE-2200
Specifications
● **Material:** Cotton
● **Size:** 520×520mm
● **Color:** Blue, Red

GREASE (GREASE ONLY)

Model: OT-GG01

GREASE GUN KIT

(GREASE GUN & GREASE)
(WITH SUNTOUR GREASE GUARD SYSTEM)
Model: OT-GG11

BOX WRENCH

Model: TA-240
Specifications
● **Material:** Steel (Chromium plated)
● **Size:** 14mm & 15mm

OPEN END WRENCH

Model: TA-190
Specifications
● **Material:** Steel (Chromium finish)
● **Size:** 16mm & 15mm

CABLE CUTTER

Model: TA-110
Specifications
● **Material:** Steel (Black plated)

CHAIN TOOL

Model: TA-300
Specifications
● **Material:** Steel
(Chromium plated)

FREEWHEEL & HUB VICE

Model: TA-120
Specifications
● **Material:** Steel
(Black & Uni chromium plated)
● **Use:** Freewheel cog

COG REMOVER

Model: TA-131
For 1/2"×3/32" chain
Model: TA-130
For 1/2"×1/8" chain
Specifications
● **Material:** Steel
● **Use:** Freewheel & Cassette cog
(Model: TA-131)
Track cog
(Model: TA-130)

FREEWHEEL REMOVER

Model: TA-320
Specifications
● **Material:** Forged steel
● **Use:** Suntour freewheel

BEARING TOOL

Model: TA-340
Specifications
● **Material:** Steel
● **Use:** Sealed bearing hub



SUNTOUR / ATB & ROAD COMPONENTS SPECIFICATION CHART

ITEM	DESCRIPTIONS	XC-PRO (MD) & XC-PRO			XC-COMP (MD) & XC-COMP			
REAR DERAILLEUR 	Model No.	RD-XP01-GXB	RD-XP01-GTB	RD-XP01-SSB	RD-XC01-GXB	RD-XC01-GTB	RD-XC01-SSB	
	Number of speed	8 & 7-Speed		7-Speed	8 & 7-Speed		7-Speed	
	Total gear capacity	39T	35T	28T	39T	35T	28T	
	Largest rear cog	30T	28T		30T	28T		
	Weight	278g	270g	239g	266g	258g	227g	
FRONT DERAILLEUR 	Model No.	FD-XP01-GXH			FD-XC01-GXH			
	Gear capacity	24T			24T			
	Clamp diameter	28.6, 31.8, 34.9mm			28.6, 31.8, 34.9mm			
	Weight	111g (28.6mm)			111g (28.6mm)			
SHIFT LEVER 	Type	THUMB SHIFTER	WISHBONE SHIFTER	X-PRESS SHIFTER	THUMB SHIFTER	WISHBONE SHIFTER	X-PRESS SHIFTER	
	Model No.	SL-XP01-RL	SL-XP20-RT,L	SL-XP10-RT,L	SL-XP01-RL	SL-XP20-RT,L	SL-XP10-RT,L	
	Number of speed	8 & 7-Speed	7-Speed	7-Speed	8 & 7-Speed	7-Speed	7-Speed	
	Weight	143g/pr.	225g/pr.	275g/pr.	145g/pr.	225g/pr.	331g/pr.	
FRONT HUB 	Model No.	HB-XP01-F			HB-XC02-F			
	Number of hole	32, 36			32, 36			
	Over locknut dimension	100mm			100mm			
	Weight	242g			234g			
FREEHUB 	Model No.	FH-XP20-8,7(MD)		FH-XP02-7	FH-XC11-8,7(MD)		FH-XC02-7	
	Number of speed	8,7-Speed		7-Speed	8,7-Speed		7-Speed	
	Number of hole	32, 36		32, 36	32, 36		32, 36	
	Over locknut dimension	130mm(7S) 135mm(8,7S)		130, 135mm	130mm(7S) 135mm(8,7S)		130, 135mm	
	Weight	454g (8S), 454g (7S)	459g		472g (8S), 462g (7S)	472g		
CASSETTE SPROCKET 	Model No.	CS-AP20-58,57(MD)		CS-AP10-S7	CS-AP20-58,57(MD)		CS-AP10-S7	
	PowerFlo	●		●	●		●	
	Number of speed	8,7-Speed		7-Speed	8,7-Speed		7-Speed	
CHAIN 	Model No.	CH-AP02, CH-AP01			CH-AP12, CH-AP11			
	PowerFlo compatible	●			●			
	Weight	321g (116 Links)			325g (116 Links)			
CRANKSET 	Model No.	CW-XP10(MD)		CW-XP01	CW-XC11(MD)		CW-XC01	
	Standard Chaining Ratio	42×32×20T (68.66T for Option)		46×36×24T	42×32×20T		46×36×24T (26T for Option)	
	Crank Length	170.0mm, 175.0mm, 177.5mm		170.0mm, 175.0mm, 180.0mm	170.0mm 175.0mm		170.0mm 175.0mm	
	Weight	638g		685g	685g		740g	
BOTTOM BRACKET 	Model No.	BB-SL10-E1.73(MD)		BB-XP00-E.73 BB-XC01-1	BB-CB00-E1.73(MD) [CASSETTE TYPE]		BB-XC01-E.73 BB-XC01-1	
	Weight	275g (E)		347g (E)	314g (E)		348g (E)	
BRAKE LEVER 	Model No.	BL-XP01			BL-XC02			
	Weight	163g/pr.			168g/pr.			
BRAKE 	Model No.	CT-XP11		CT-XP11	CT-XC02		CT-XP11	
	Self Energizing System	—		●	—		●	
	Shoe stroke	22.5 - 28.0mm		22.5 - 27.5mm	22.0 - 28.0mm		22.5 - 27.5mm	
	Weight	170g/pr.		239g/pr.	170g/pr.		239g/pr.	
PEDAL 	Model No.	PL-XP02	PL-XP10	PL-XP11	PL-XC03			
	Grease Guard System	●	—	—	—			
		Titanium	—	●	—	—		
		Cr-Mo Steel	●	—	●	—		
		Boron Steel	—	—	—	●		
	Step-in type	—		●	—			
Weight	305g	410g	455g	315g				
HEAD SETS 	Model No.	HS-XP02-J	HS-XP02-1	HS-XP02-OS	HS-ST00-J	HS-ST00-1	HS-ST00-	
	Threading (BC)	1" × 24T			1-1/8" × 26T		1" × 24T	
	Race Diameter	Upper Cone & Lower Cup	30.5mm	30.2mm	34.0mm	30.5mm	30.2mm	30.5mm
		Lower Cone	27.0mm	26.4mm	30.0mm	27.0mm	26.4mm	27.0mm
	Weight	127g			136g		122g	
SEAT POST 	Model No.	SP-XP00			SP-XP00			
	Diameter	26.0mm, 26.8mm, 27.0mm, 27.2mm			26.0mm, 27.0mm, 27.2mm			
	Weight	290g			290g			

XC-LTD		XC-EXPERT (MD)	
RD-XL00-GXB		RD-XX00-GXB	RD-XX00-GTB
7-Speed		8 & 7-Speed	
39T		39T	35T
30T		30T	28T
38g		31g	29Tg
FD-XL00-GXH		FD-XX00-GXH	
24T		24T	
28.4, 31.8, 34.9mm		28.5, 31.8, 34.9mm	
112g (28.6mm)		112g (28.6mm)	
WASHONE SHIFTER	X-PRESS SHIFTER	THUMB SHIFTER	TWIST SHIFTER
SL-XX00-RT,L	SL-XL10-RT,L	SL-XX00-RL	TS-XX00-RL
7-Speed		8 & 7-Speed	
22g/pr.		14g/pr.	45g/pr.
HB-XL00-F		HB-XL00-F	
32, 36		32, 36	
100mm		100mm	
239g		239g	
FH-XL01-T		FH-XX00-8,7 (MD)	
7-Speed		8,7-Speed	
32, 36		32, 36	
130mm, 135mm		135mm (85, 75) 130mm (75)	
47g		47g (85) 46g (75)	
CS-AP10-KT		CS-AP20-K8 (MD)	CS-AP20-KT (MD)
7-Speed		8-Speed	7-Speed
29g (12~28)		31g	23g
CH-AP11		CH-AP12, CH-AP11	
325g (116 Links)		325g (116 Links)	
CW-XL00		CW-XX00 (MD)	
46x38x24T (26T for Option)		42x32x20T	
170.5mm 175.5mm		170.5mm 175.5mm	
720g		733g	
BB-KC01-E,T3 BB-KC01-I		BB-CR00-E,T3 (MD) [CASSETTE TYPE]	
348g (E)		314g (E)	
BL-XL00-S		BL-XX00	
262g/pr.		192g/pr.	
CT-XL00		CT-XX00	
22.5 - 27.5mm		22.5 - 27.5mm	
170g/pr.		170g/pr.	
PL-XL00		PL-XL00	
395g		395g	
HS-ST00-I		HS-ST00-J	HS-ST00-I
1" x 24T		1" x 24T	
30.2mm		30.0mm	30.2mm
26.4mm		27.0mm	26.4mm
122g		122g	

● is also available with XC-EXPERT (MD).

SUPERBE-PRO				SL	
RD-SB00-SSB				RD-SL00-SSB	
8, 7 & 6-Speed				8, 7 & 6-Speed	
26T				24T	
28T				26T	
194g				191g	
FD-SB00-SSH		FD-SB00-SSB		FD-SL00-SSH	FD-SL00-SSB
16T				16T	
28.6, 31.8mm		Brake-on		28.6, 31.8mm	Brake-on
96g		92g		99g	96g
Down-tube				Down-tube	
SL-SB02-8,8F				SL-SL01-8,8F	
8 & 7-Speed				8 & 7-Speed	
89g/pr.				85g/pr.	
HB-SB00-F				HB-SL01-F	HB-SL10-F (Microsite)
28, 32, 36				32, 36	24, 28, 32
100mm				100mm	100mm
240g				221g	180g
FH-SB00-8,7				FH-SL01-8,7	FH-SL10-T (Microsite)
8,7-Speed				8,7-Speed	7-Speed
28, 32, 36				28, 32, 36	28, 32
126mm (75) 130mm (8, 75)				126mm (75) 130mm (8, 75)	126mm 130mm
464g (85) 458g (75)				464g (85) 452g (75)	405g
CS-AP10-S8	CS-AP00-S8	CS-AP10-S7	SC-AP00-S7	CS-AP10-S8	CS-AP10-S7
8-Speed	8-Speed	7-Speed	7-Speed	8-Speed	7-Speed
27g	27g	25Tg	25Tg	27g (12~24)	25Tg (12~21)
CH-AP02, CH-AP01				CH-AP12, CH-AP11	
325g				325g	
CW-SB10				CW-SL00	
52x42T				52x42T	
165.0mm, 167.5mm, 170.0mm, 172.5mm, 175.0mm				165.0mm, 170.0mm, 175.0mm	
683g				686g	
BB-SB11-E,I		BB-SB20-E,I (Microsite)		BB-CB00-E,I [CASSETTE TYPE]	BB-SL10-E,I (Microsite)
309g (E)		265g (E)		314g (E)	270g (E)
BL-SB11				BL-SL00	
236g/pr.				260g/pr.	
BA-SB01-S				BA-SL00-S	
39-49mm				39-51mm	
362g/pr.				290g/pr.	
PL-SB00		PL-TM00		PL-TM00	
290g				476g	
HS-SB00-J		HS-SB00-I		HS-ST00-J	HS-ST00-I
1" x 24T				1" x 24T	
30.0mm				30.2mm	
27.0mm				26.4mm	
119g				122g	
SP-SB00-S,L					
25.0mm, 26.8mm, 27.0mm, 27.2mm					
250g (SP-SB00-S)					

OUR DEDICATION TO PERFECTION

SR SAKAE has been a pioneer in producing cost efficient alloy components. A strong commitment to R&D results in new products that are innovative and reliable at an economical price point. We have developed new alloy technologies including Litage (our exclusive process for alloy bonding) Pressure Fit and Accurad Forging. These processes allow us to mass produce excellent quality products at minimal costs. Our aim is dedication to "Quest for Perfection."



AC4C Accurad Forging Machine



Litage Dual Bonding Process

SR Suspension Fork: Continuing a tradition of design and manufacturing excellence, SR introduces the DuoTrack suspension fork: a well built, affordable suspension system designed to meet the needs of the recreational rider as well as the moderate off road enthusiast. By smoothing out the bumps and potholes the SR Duo Track Fork reduces fatigue and puts the fun back into a long day's ride.

Features:

Spring suspension with elastomer, damper
High strength steel springs smooth out the ride and the elastomer dampers take the pounding out of even the biggest bumps.

NSP Aluminum Tubing

The NSP fork blades are light in weight, high in strength and have exceptional fatigue resistance. The large diameter fork blades resist torsional stress much more effectively than do small diameter blades, which improves control of the bike under rough conditions. The tough, anodized finish will maintain its great looks for years.

Accurad Forged AC4C Aluminum lugs

The crown and brake arch are Accurad Forged and have a T-6 heat treatment. Accurad Forgings are significantly stronger and less brittle than die castings, assuring many years of riding enjoyment.

FRONT FORK

Litage Thermal Bonded Fork

Available in road or mountain versions, the alloy road forks and ATB forks are available in various steerer tube length from 130-260mm. 26" alloy mountain forks with eyelets are also available.





Fork Crown and Steerer Tube

The Ishiwata Chromoly steerer tube and the Nickel/Chrome plated chromoly struts are securely bonded to an Accurad Forged fork crown using the patented Litage Process. The resulting joint is extremely strong and reliable.

The Accurad Cast fork crown has been specially designed to maximize control of the bike and minimize weight. By placing the fork blades in front of the center of the steerer tube, the action of the suspension system is improved and the effect of the fork movement on the steering geometry is reduced.

Specifications:

- Cantilever brake bosses standard
- Wheel size 26"
- Fork Travel: 35 mm (1.37")
- Fork offset: 45 mm (1.77") – 10 mm in crown, 5 deg angle on steerer
- Weight 1,480 g (3.1 lbs.)
- 22.2 and 25.4 mm steerer versions available

Please be sure to use the cable safety holder (Model: OT-SH01 for DuoTrack) for your safe riding.

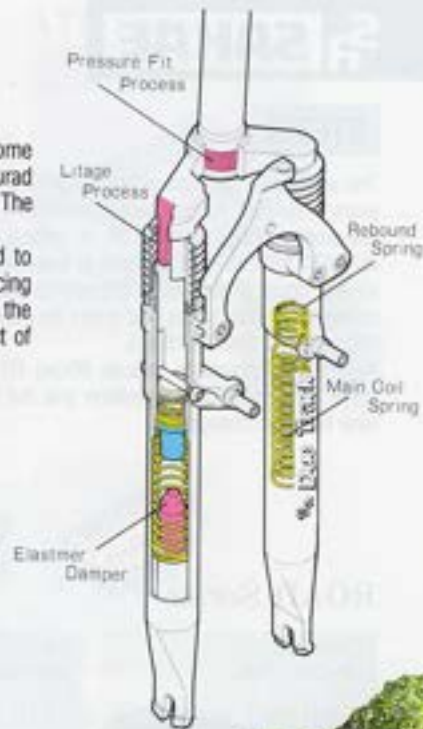

HANDLEBAR

SR first began producing bicycle parts over 40 years ago. The first product made was a handlebar, and the tradition of producing some of the best handlebars in the world continues. For 40 years SR has made strong reliable handlebars at economical prices. Today you'll find bars for every application of cycling: aluminum and titanium mountain bike bars, anatomic road racing bars, and touring bars.

ATB Series Powerbulge Quad-2 Alloy



BR-MTB-226SB

Powerbulge Titanium



BR-MTB-420AS

Stainless ZETTO



BR-MTB-528AS

ROAD Series

Cable groove Anatomic BR-CMB-201



Standard Anatomic BR-FMB-200-DM



STEMS

The worldwide standard in MELT FORGED STEMS for over 20 years. The SR name means consistent high quality at a reasonable price. Because fit is critical to riding comfort, ACCURAD STEMS are available in extensions from 40mm for smaller riders all the way to 120mm for extra extension. A wide variety of heights, styles and prices for every kind of bike make SR stems the obvious choice.

Recent SR innovations include 90deg HYBRID STEMS for a more comfortable riding position and the hinged CTS-320 for easy bar/stem changes.

ROAD Series

Custom
HP-CTS-320BL



FX
HP-FXS-100DM



City Series

City
HP-CYS-120BLA



ATB Series

MTS
HP-MTS-301BL



ZETTO
HP-MTS-455BL



SEATPOSTS

ATB Series

TCO
SP-MTE-315HG2



Tall Cool One (TCO)

The tall, the cool, the only, the TCO. The special ACCURAD FORGED T6 heat treated head is Pressure Fit to an NSP 5056 hard anodized alloy tube for the ultimate high strength seat post. Lengths available: 250 mm, 300 mm, 350 mm.

The TCO sport series combines the same ACCURAD FORGED head and Pressure Fit bond as the TCO. With a reasonable price for the best value Tall Cool seatposts. Lengths available: 250mm, 300mm.

TCO sport
SP-MTE-325



MTE
SP-MTE-335



'93 NEW



CTE-100

ROAD Series

FX
SP-FXE-100DM



PEDALS

Unique design to meet every cyclist needs.

THE LOWFAT CONCEPT

A thin profile for high cornering clearance. A wide platform for a good grip. Great looks and a fair price. With a re-designed tooth profile for easier entry and exit, double toe flips, and a range of cages and finishes to fit every budget, the **LOWFAT** series is the ATB pedal of choice for both racers and sport enthusiasts. For the retail market, special **LOWFAT** packaging is available.

MTP-129 LOWFAT COMP
MTP-127 LOWFAT LTD
MTP-126 LOWFAT
MTP-170 LOWFAT SPORT
MTP-426
MTP-481

Low Fat
PL-MTP-126BL



ATB Series

Low Fat Comp
PL-MTP-129HG



ATB
PL-MTP-481FB



PL-SP-530FB



ATB
PL-MTP-127

ROAD & HYBRID Series



Hybrid
PL-CTP-470BLA



Road
PL-CTP-400AL



Road
PL-SP-150-SE



Road
PL-SXP-102BL

City & Fashion Series



Fashion
PL-SP-550FB



Fashion
PL-SP-563FB

CASSETTE BOTTOM BRACKET

High Quality. High Performance. Easy Maintenance.

This sealed bearing unit protects the bearings from contaminants such as sand, mud, water and dirt. Easy to install and requires little or no adjustments.

'93 NEW



BB-CB10

BB-CB00



TOE CLIP & STRAP



AS-30BL

AC-51BL

CRANKS/CHAINRINGS

SR's main product is cranksets. From simple steel single cranks to the lightest ATB racing cranks, SR has it all.



SW-SES-631-BL2



TANDEM

CW-CSC-Tandem



Ninja
300T



Platinum
300T (Inner),
300C (Center),
310 (Outer),
200 (Outer & lanner),



Round Tech
300T (Inner),
300C (Center),
310 (Outer),
200 (Outer & lanner),



*The environment is our future,
please ride responsibly*

SR SUNTOUR USA, INC.
18650 72nd Ave. S. Kent Washington 98032 U.S.A.

SR SUNTOUR EUROPE
2-4, Rue de Praetere P.O. Box 57-1050,
Bruxelles Belgique

SR SUNTOUR, INC.
555-1 Kanaoka-cho, Sakai-shi, Osaka Japan 591

SAKAE TAIWAN CO., LTD
No. 7, Hsing Yeh RD., Fu Hsing Industrial Zone
Changhua, 5056, Taiwan, R.O.C.

1992 SR SUNTOUR SMALL PARTS CATALOG

The 1992 SR SUNTOUR Small Parts Catalog is now available and ready to ship! The new Small Parts Catalog features complete blow-apart-diagrams detailing the individual parts of all current SR Suntour components including Grease Guard® and MicroDrive.

The Small Parts Catalogs are \$10.00 each including shipping and handling. Please enclose a check or money order (please do not send cash) along with this card and send to:

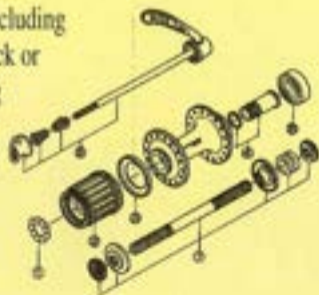

SR SUNTOUR
18650 72nd Ave. S.
Kent, WA 98032

Please allow 4 to 6 weeks for delivery

Shop Name _____

Street Address _____

City, State, Zip _____

Contact Person _____

Phone _____

Number of catalogs _____ X \$10.00 = _____